

XF-10MDT4X65-1C-VI

Specificaliton

Optical structure	Telecentric
Magnification	4
Object field of view	Φ4.4mm
Image field of view	Φ17.6mm
Working Distance	65mm±3%
Telecentricity	<0.16°
Depth of field	0.08—1.4mm
F#	F11.8—194.9
Resolution	2.0—32.3μm
MTF	>0.3@85—5lp/mm
Distortion	<0.090%
Detector type:	
1.1' 14.2×10.4	3.6×2.6mm
2/3' 8.45×7.07	2.1×1.8mm
1/2' 6.4×4.8	1.6×1.2mm
1/3' 4.8×3.6	1.2×0.9mm

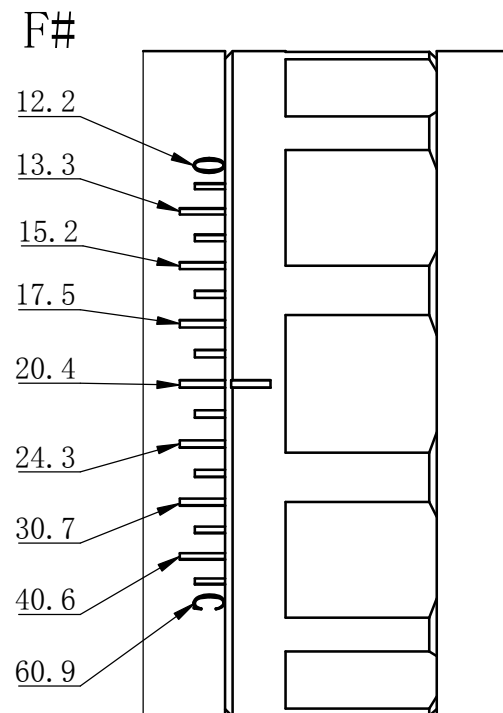
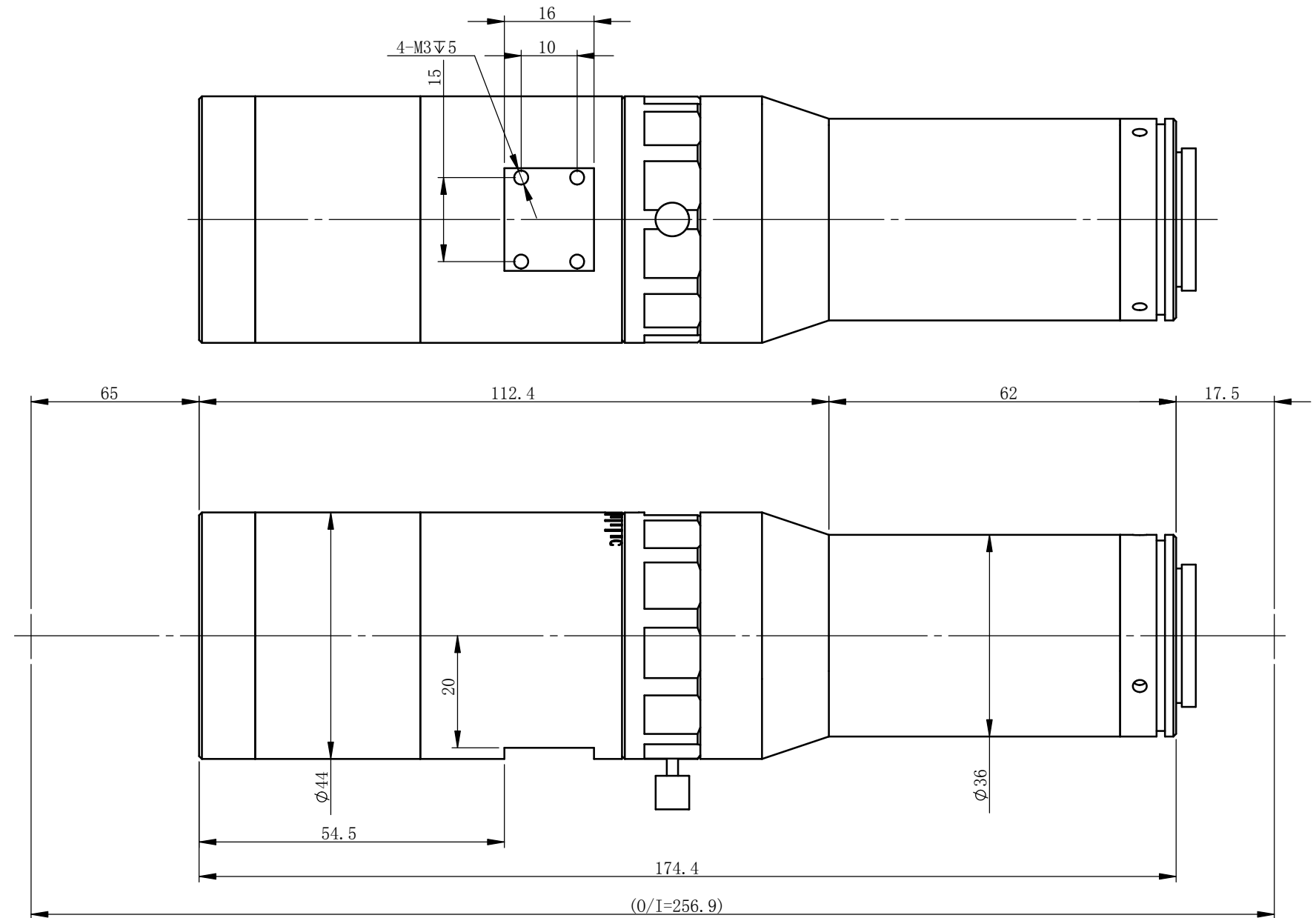

Undefined tolerance (mm)	degree	File Name			
X. X	±0.2	±30min	XF-10MDT4X65-1C-VI-外形尺寸-EN		
X. XX	±0.02	Drawing Name			
X. XXX	±0.005	Drawing Size: A3			
	Sign	Data/Ver.	Material	Ratio	Product Name
Design				1:1	
Modify1			Qty		Canrill OPTICS
Modify2			Total:	Page:	All design and drawings are intellectual property of Canrill Optics, can not be copied without Canrill's authorization.